

A number one hit for years, the GFD165 is the smallest unit of the GF series to date.

With a maximum of 160 kV and 5 mA, the GFD165 is a compact gas insulated unit designed for applications where size and weight matter. The GFD165 is the ideal machine for field applications where the unit needs to be frequently moved or inserted in tiny spaces. With regards to its 5mA and pulsed wave technology, the unit can penetrate medium to very thin materials, metallic or composites. It will easily surpass the poor contrast of Isotopes and will be a very interesting replacement in lower thickness ranges where Isotopes are generally not allowed.

This unit utilizes the same driving electronic and technologies as the CERAM but is equipped with the standard well proven glass tube of Balteau NDT.

It has to be combined to one of the two available types of control units (CF2000 or Hand X). It is self recognized by any of our control units. The power consumption is the lowest of the range which makes it the perfect candidate for mobile inspections.



Size and performances

When looking to it you'll see a very small unit, but don't under evaluate the capacity of this well proven equipment. It is used in various fields of applications, from oil and gas to aerospace and this for more than 25 years now. The unit has been totally redesigned and upgraded to the latest technology but the very heart of it is still made according to the same high standard requirements and efforts to perfection. The simplicity of the construction is giving the user the assurance that support when required can easily be given.

This equipment is the right combination with a bigger unit when inspection of heavy walled or high absorbing materials are occasional or can be a secondary unit.

Energy savers

Power waste is concerning every industry and all actions contributing to the decrease of wasted energy can create big savings when added one to one. An efficient system can only be if the regulation of power supply is efficient and if the technology used is the most advanced. The technology we have used in the high voltage transformer cuts the power need by two to produce the same output with a competitor product. On the regulation side, our units can accept wide variations on the input without effect on the output.

Pulsed wave high voltage generator

Pulsed wave technology is the only acceptable compromise between power and contrast which are representing economy and quality requirements. Pulsed wave generators can drive a higher current at full power and will still keep an extremely broad spectrum to guarantee that soft X-rays will be present even at full kV giving a contrast that is not achievable with any other techniques at same kV.

Field operation

All our portable units are designed to operate on power generator when required. Safety oriented, our units are bright yellow to be easily sight located and can even be equipped with additional lights on the can that will indicate the working status (option). A specific micr²o chip identifies each generator and brings our control unit the ability to instantaneously recognize the equipment connected and adapt the best parameters to drive the new generator. Our main connectors are original military ITT CANNON plugs for years. Additional accessories from clignotix, filters, laser pointers, stands or specific cradles for centering in pipelines are available.

Specifications

Mechanical

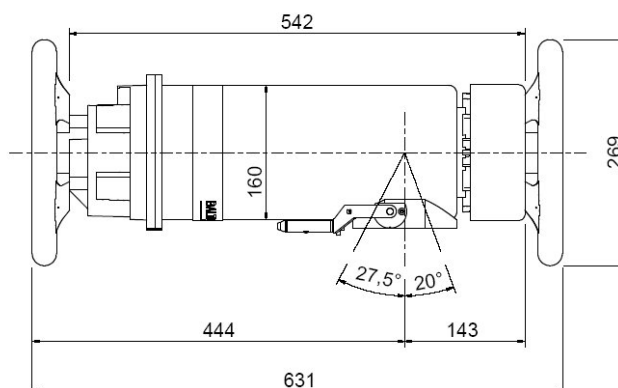
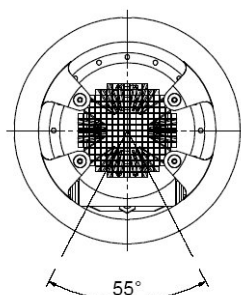

Weight without rings : 12 kg

Electrical

High voltage range	kV	50 – 160
Tube current range	mA	0,1 – 5
Duty cycle		100%*
Insulation		SF6 gas
Mains	V	180-260

* at a temperature of 30°C reduced mA

X-ray tube

Beam angle		55°
Focal spot size (IEC336)		1,5 x 1,5
Inherent filtration	mm	6 Al
Anode cooling type		Air

Environmental

Operating temperature	°C	Max. 70
-----------------------	----	---------

Standard equipments

Internal pressure gauge, heavy duty lock type connector, 20 m connecting cable, quick release SF6 valve, heavy duty rubber coated hand rings, holder for centering device filter and diaphragm.

Optional accessories

Lead shutter, warning light, warning light repeater, bag for accessories, transport case, cradle, support stand, hydraulic stand, 100-260 V adapter.

Producer

Balteau NDT sa

Voie de Liège, 12
B-4681 Hermalle Sous Argenteau
BELGIUM

Tel.: +32 4 374 75 75
Fax: +32 4 374 75 85
E-mail: balteau@balteau-ndt.com
Website: www.balteau.com

Distributor